

Cascading Kit Breaker Locks Installation Guide

Components

The breaker lock kit included in the cascading kit (part number ACPE000100 from AddÉnergie) is designed to be installed on the associated 100 A breaker circuit (model EA2-0 from Carling Technologies). The breaker lock kit includes the following components:

Image No.	Component	Qty
1	Breaker lock pivot	2
2	Breaker lock pin	2
3	Breaker lock arm	2
4	18-8 stainless steel pan head Phillips machine screw, 6-32 thread, 5/8" length (max. torque: 8 LB-IN [0.9 NM])	8
5	Breaker lock stopper	2
6	Breaker lock upper cover	2

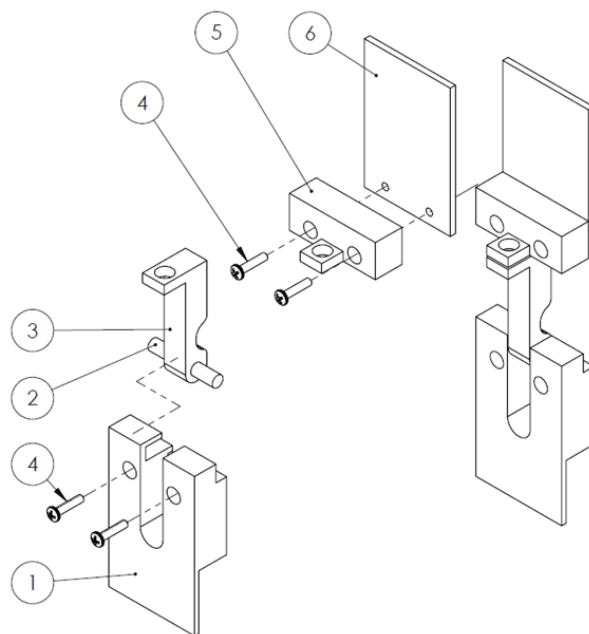

Installation

1. Place the breaker lock pin inside the breaker lock arm hole.
2. Place the pin on the breaker lock pivot notch.
3. Fix the breaker lock pivot to the double circuit breaker using the 2 screws provided (max. torque: 8 LB-IN [0.9 NM]), making sure the pin stays between the notch and the breaker.
4. Place the breaker lock stopper against the upper stopper and fix them on the double circuit breaker using the 2 screws provided (max. torque: 8 LB-IN [0.9 NM]).
5. Repeat steps 1–4 for the second breaker lock.

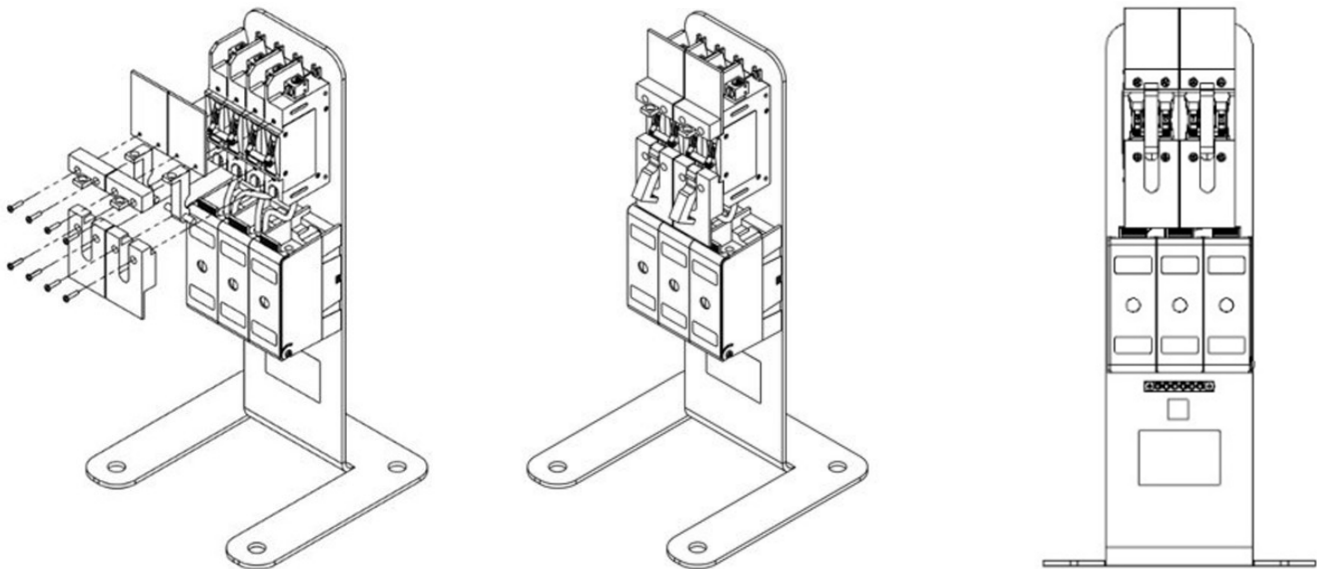

Name: FLO_CoRe+ MAX_Cascading Kit Breaker Locks Installation Guide_V.2.0.1_2023-01-25_CA_US_EN

ID: PRFM0048

FLO CA: © 2022-2023 Services FLO Inc., All rights reserved. FLO, the FLO logo, LEAD THE WAY, and TRACEZ LA VOIE are trademarks of Services FLO Inc. ADDÉNERGIE is a trademark of AddÉnergie Technologies Inc. used under license by Services FLO Inc.

FLO US: © 2022-2023 FLO Services USA Inc., All rights reserved. FLO, the FLO logo, LEAD THE WAY, and TRACEZ LA VOIE are trademarks of Services FLO Inc. used under license by FLO Services USA Inc. ADDÉNERGIE is a trademark of AddÉnergie Technologies Inc. used under license by FLO Services USA Inc.

ALL Documents: This document is provided as a general instruction guide. All pictures shown are for illustration purposes only. Actual stations may vary in size or due to product enhancements, in which case additional steps may be required. AddÉnergie Technologies Inc. and its subsidiaries ("AddÉnergie") reserve the right to alter this document and any product offerings and specifications at any time without notice and AddÉnergie does not guarantee that that this version of the document is current. It is your responsibility to comply with all applicable laws, including those related to accessibility, zoning, and to exercise due diligence when conducting an installation or using this product. Careless installation or use may result in injury or product damage. To the fullest extent permitted by applicable laws, AddÉnergie disclaims any liability for personal injury or property damage resulting from the installation or use of this product.