

# CoRe+ MAX™

## Connector Cable Replacement Guide



# Table of Contents

1. Introduction .....	3
1.1. Safety .....	3
1.1.1. Safety Symbols on your Unit .....	3
1.1.2. Instructions Pertaining to the Risk of Fire or Electric Shock .....	3
1.1.3. Important General Safety Instructions .....	4
2. Cable Replacement Procedure .....	5
2.1. Removing the Front Cover .....	5
2.2. Replacing the Charging Cable .....	6
2.3. Closing the Front Cover .....	9
3. Copyright and Liability .....	12

# 1. Introduction



This guide describes how to replace the CoRe+ MAX™ connector cable. Read the following safety instructions and procedures carefully.

## 1.1. Safety



Read all the instructions before using this product.

PLEASE SAVE ALL THE INSTRUCTIONS OF THIS MANUAL.

### 1.1.1. Safety Symbols on your Unit

Symbol	Meaning
	Alternating current
	Phase
	This unit is equipped with a protective conductor terminal.

### 1.1.2. Instructions Pertaining to the Risk of Fire or Electric Shock

Symbol	Meaning
	<p>This symbol is used to warn you about hazardous voltage and the possibility of electric shock.</p> <p>When using electrical products, basic precautions should always be followed, including the following. This manual contains important instructions for the CoRe+ MAX model that must be followed during the installation, operation, and maintenance of the unit.</p>
	<p>This symbol is used to make you aware of important safety information in these instructions.</p>

### 1.1.3. Important General Safety Instructions

Always follow the safety instructions below when replacing the connector cable.

- Contact a certified contractor, a certified electrician, or a trained installer to ensure compliance with local building codes, regulations, safety standards, and weather conditions.
- Make sure to always disconnect the power supply of the EVSE before servicing it. Ensure that there is no remaining power before replacing the cable.
- Avoid replacing the cable in bad weather conditions.
- Only use a FLO-certified replacement cable.



#### **CAUTION**

Always use a manual screwdriver. **DO NOT** use power tools for the screws at any time. This will void the warranty.

## 2. Cable Replacement Procedure

### 2.1. Removing the Front Cover

1. Make sure to disconnect the power going to the charging station by opening the corresponding breaker on the breaker panel. Secure the breaker with a lock (not provided). Ensure that there is no remaining power in the input terminal block before performing any operations on the charging station.
2. Remove the four screws on the front cover. Apply slight pressure to the cover while removing the screws to prevent it from falling.

**WARNING:** NEVER USE POWER TOOLS TO AVOID DAMAGING THE THREADS!

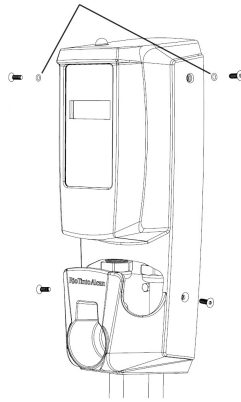

3. While holding the cover, pull on it slowly and carefully to bring it backwards, then rotate it to the left to expose the data cable. Disconnect the data cable connector from the charging station and put the cover away.

**WARNING:** NEVER CONNECT/DISCONNECT THE DATA CABLE WHEN THERE IS POWER IN THE CHARGING STATION. THIS COULD DAMAGE THE UNIT.

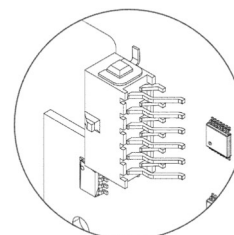
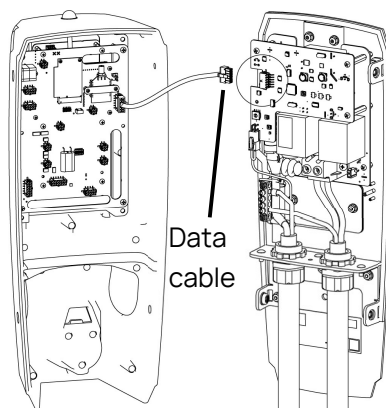

Data cable connection point

## 2.2. Replacing the Charging Cable

4. Locate the charging cable on the left side of the charging station. Disconnect its four cables:
  - a. Power cable (L1 and L2): By unscrewing the screws located beside the fuse
  - b. Signal cable: By disconnecting the quick disconnect connector
  - c. Ground cable (GND): By unscrewing the screw on the ground terminal

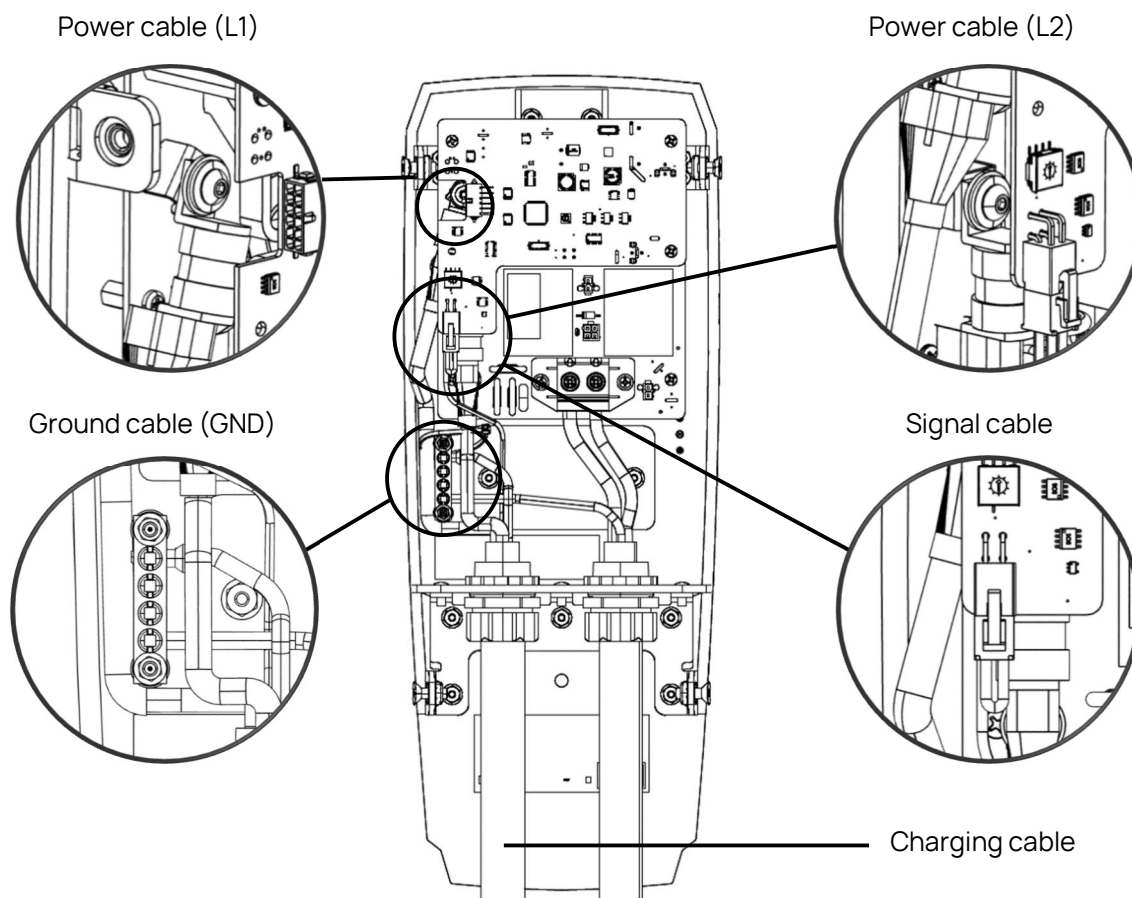

5. Unscrew and remove the charging cable locknut while making sure to hold the cable so that it does not fall to the ground.

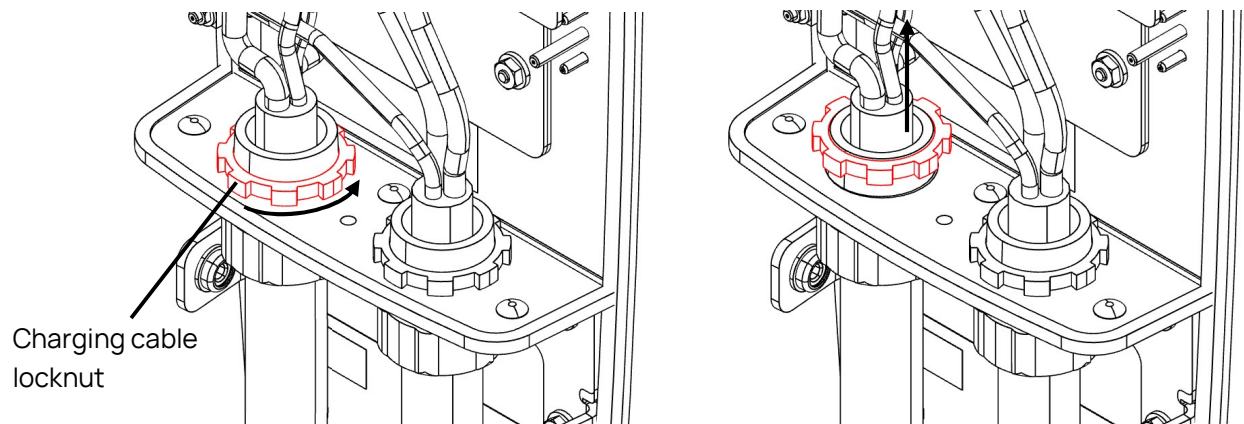

6. Pull the charging cable and its four cables (L1, L2, GND, and Signal) down out of the lip opening. Pass the cables one by one into the lip opening.

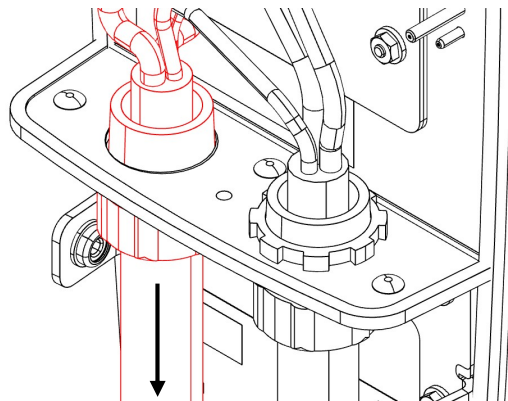

7. Unscrew and remove the locknut from the new charging cable.
8. Insert the new charging cable and its four cables (L1, L2, GND, and Signal) into the lip opening on the left side of the charging station. Make sure that the O-ring stays in place and seals the lip properly with the cable strain relief.

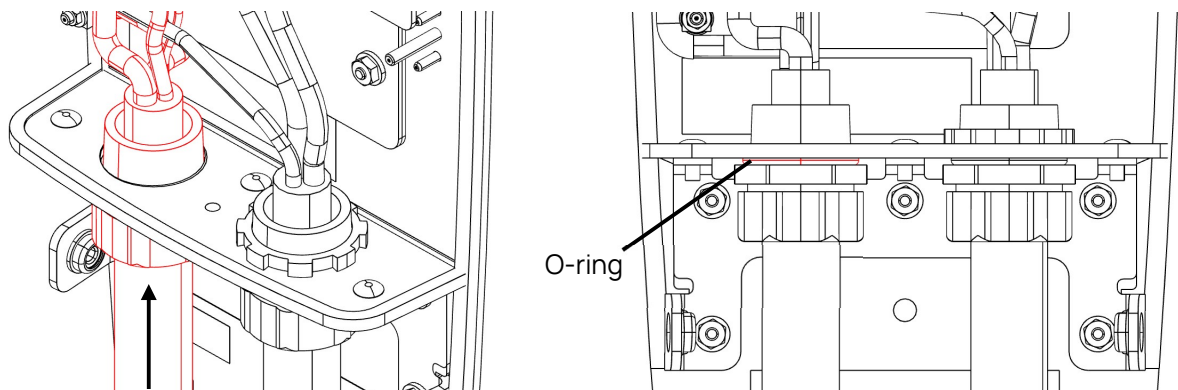

9. Pass the locknut into the charging cable and its four cables (L1, L2, GND, and Signal) and tighten it to the strain relief connector.

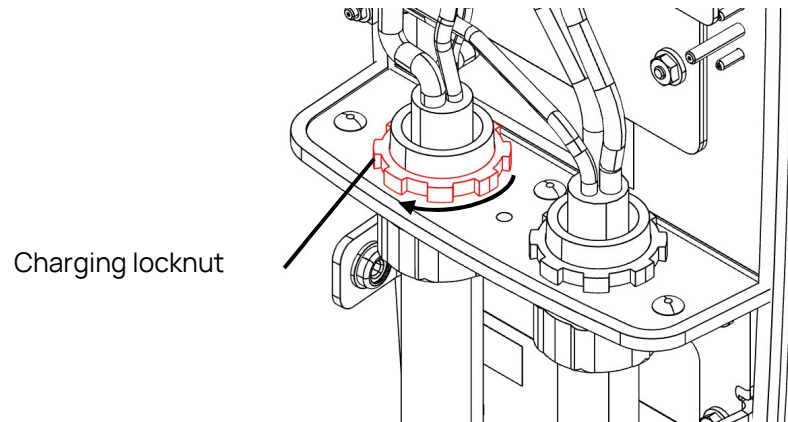

10. Tighten the strain relief connector, ensuring that the cables are long enough to reach the terminals.

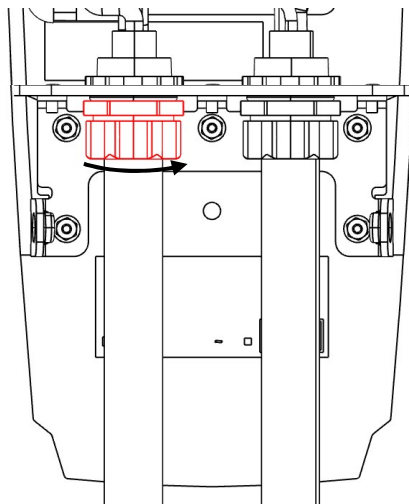

11. Connect the cables to their respective terminals. Refer to the images in step 4.
- a. Ground cable (GND): Tighten the screw to 25 lbs./in. (2.8 N-m)
  - b. Power cables (L1 and L2): Tighten the screws to 40 lbs./in. (4.5 N-m)
  - c. Signal cable: Connect the quick connect connector



## 2.3. Closing the Front Cover

1. Make sure that the gasket on the lip shown below is properly aligned.

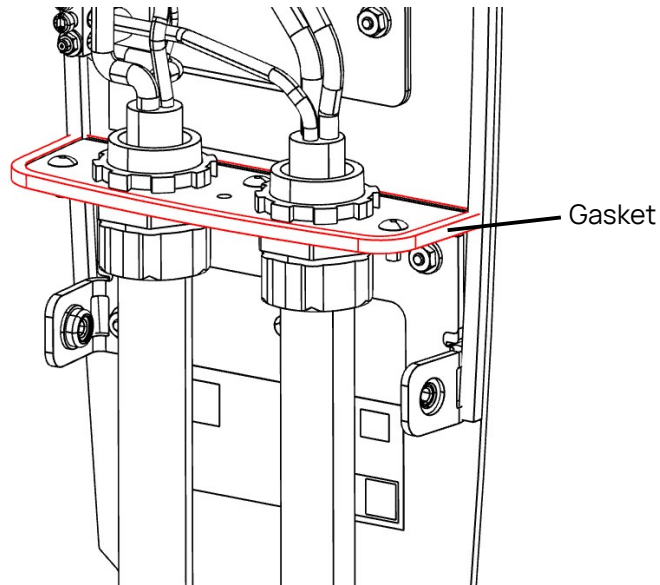

2. Connect the data cable to its respective connector as shown below.

**WARNING:** NEVER CONNECT/DISCONNECT THE DATA CABLE WHEN THERE IS POWER IN THE CHARGING STATION. THIS COULD DAMAGE THE UNIT.

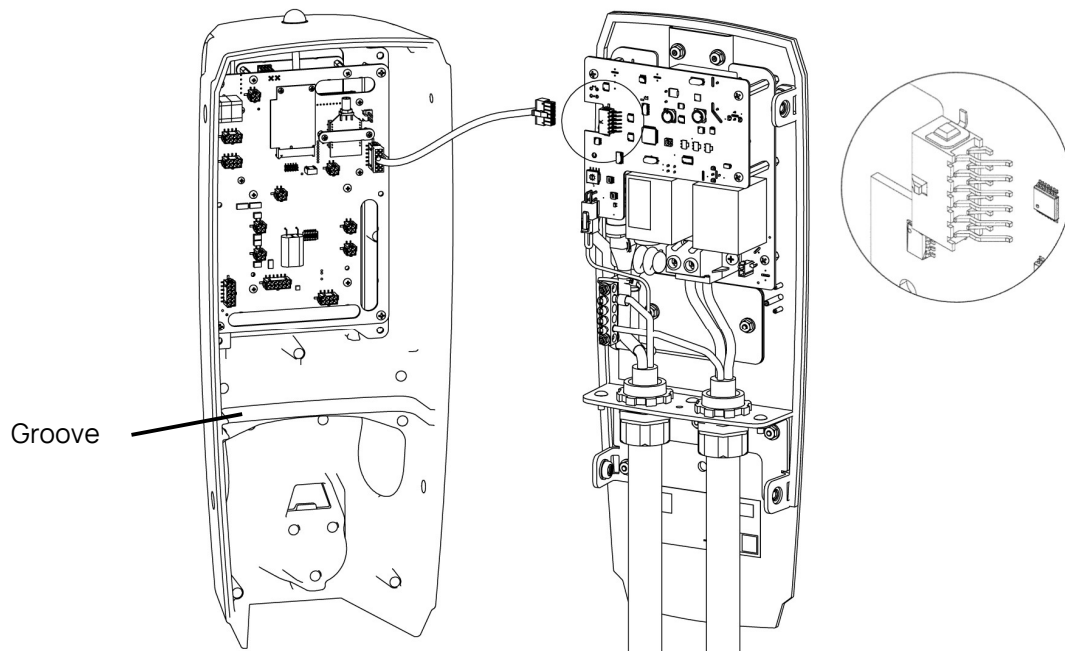

3. Align the housing groove to the charging station lip and push the housing toward the charging station, ensuring that the gasket stays in place.

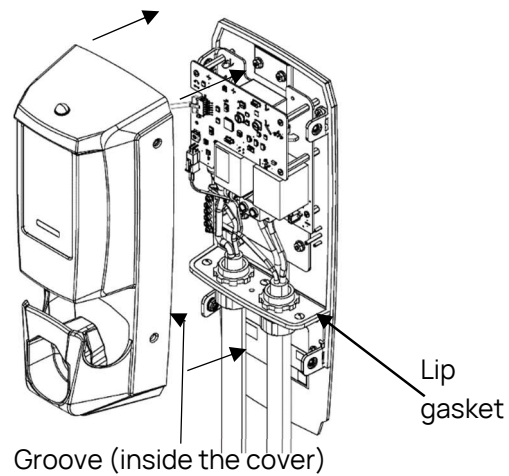

4. Apply slight pressure to the front cover, then screw on the top 2 bolts, ensuring that the O-rings stay on the screws. Screw on the bottom 2 bolts (no O-rings on the bottom bolts). Tighten all screws to a maximum of 30 lbs./in. (3.4 N-m).

**WARNING:** NEVER USE POWER TOOLS TO AVOID DAMAGING THE THREADS!

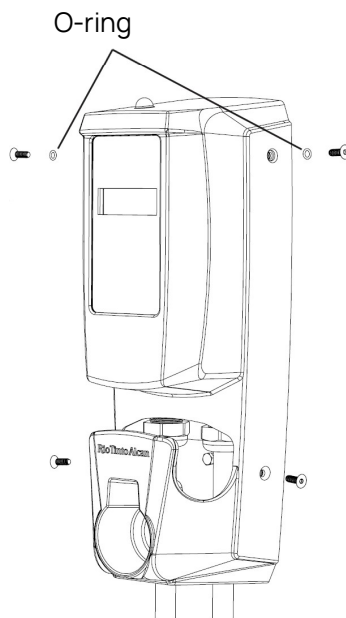

5. Place the charging cable on the cable holder and the charging connector in the receptacle.

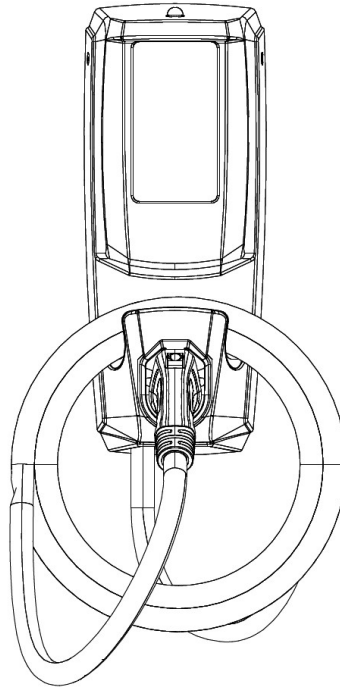

6. Apply power to the charging station by closing the relevant breaker on the breaker panel.
7. Ensure that the charging station works correctly.
  - a. If the station was out of service prior to your call, call your D&S contact to put it back into service.
  - b. Validate the information on the CSNMS page with your D&S contact.
  - c. Using an EV or—if available—the car simulator with the switch in position “B,” initiate a charging session by moving the switch from position “B” to “C” in order to ensure that there is an energy transfer between the station and the heater connected to the car simulator.
  - d. Validate whether the energy transfer appears in CSNMS with your D&S contact.
  - e. Put the charger back into place on the charging station.

### 3. Copyright and Liability

FLO\_CoRe+ MAX\_Cable\_Replacement\_Guide\_V1.0.0\_2022\_09\_23\_CA\_US\_EN

**FLO CA:** © 2022 Services FLO Inc. All rights reserved. FLO, the FLO logo, LEAD THE WAY, and TRACEZ LA VOIE are trademarks of Services FLO Inc. ADDÉNERGIE is a trademark of AddÉnergie Technologies Inc. used under license by Services FLO Inc.

**FLO US:** © 2022 FLO Services USA Inc. All rights reserved. FLO, the FLO logo, LEAD THE WAY, and TRACEZ LA VOIE are trademarks of Services FLO Inc. used under license by FLO Services USA Inc. ADDÉNERGIE is a trademark of AddÉnergie Technologies Inc. used under license by FLO Services USA Inc.

This document is provided as a general instruction guide. All pictures shown are for illustration purposes only. Actual stations may vary in size or due to product enhancements, in which case additional steps may be required. AddÉnergie Technologies Inc. and its subsidiaries (“AddÉnergie”) reserve the right to alter this document and any product offerings and specifications at any time without notice and AddÉnergie does not guarantee that that this version of the document is current. It is your responsibility to comply with all applicable laws, including those related to accessibility, zoning, and to exercise due diligence when conducting an installation or using this product. Careless installation or use may result in injury or product damage. To fullest extent permitted by applicable laws, AddÉnergie disclaims any liability for personal injury or property damage resulting from the installation or use of this product.

## Contact us

Telephone: 1 855 543 8356

Email: [Info@flo.com](mailto:Info@flo.com)

Website: [Flo.com](http://Flo.com)



Eastern office: 2800, Louis-Lumière Street, office 100, Québec, QC, Canada – G1P 0A4

Regional office – Western Canada: #501 – 4190 Lougheed Highway, Burnaby, BC, Canada  
– V5C 6A8

United States office: 75 South Clinton Ave., suite 510, Rochester, NY, USA – 14604